

# Your washing machine

**Congratulations** - you have opted for a modern, high-quality domestic appliance manufactured by Bosch. This washing machine is distinguished by its economical water and energy consumption. Each machine that leaves our factory is inspected thoroughly to ensure that it functions properly and is in perfect condition.

For further information about products, accessories, spare parts and services visit our web site [www.bosch-home.com](http://www.bosch-home.com) or contact our after-sales service centres.

## Contents

Intended use	1
Programmes	1
Setting and adjusting the programme	3
Washing	3/4
After washing	4
Individual settings	5/6
Overview of programmes	7
Safety instructions	8
Consumption values	9
Important information	9
Insert for liquid detergent	10
Care	10
Information on the display panel	10
Instructions for blockages	11
What to do if ...	12
Emergency release	13
After-sales service	13

## Environmental protection/Conservation tips

- Always fill the washing machine with a maximum amount of laundry for the relevant programme.
- Wash normally soiled laundry without a prewash.
- Instead of **Cottons 90 °C**, select the **Cottons 60 °C** programme along with the additional **EcoPerfect** function. Comparable cleaning with significantly lower energy consumption.
- Measure the detergent according to the manufacturer's instructions and water hardness.
- If the laundry is then dried in the tumble dryer, select the appropriate spin speed according to the instructions of the dryer manufacturer.

## Intended use

- For domestic use only
- for machine-washable fabrics and hand-washable wool in detergent solution,
- To be operated with cold mains water and commercially available detergents and care products which are suitable for use in washing machines.

- Do not leave children unattended near the washing machine
- The washing machine is not to be used by children or persons not familiar with the operating instructions
- Make sure your hands are dry.
- Take hold of the plug only.
- Keep pets away from the washing machine.

## Preparation

Correct installation according to the separate installation instructions.

**Check the machine**  
- Never use a damaged machine.  
- Inform the after-sales service.

**Connect the mains plug**  
- Make sure your hands are dry.  
- Take hold of the plug only.

**Turn the tap on**

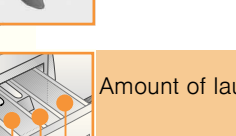
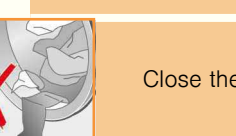

## Sorting and loading the laundry

Please note the manufacturer's care information. According to the information on the care labels. According to type, colour, soiling and temperature. Do not exceed the maximum load → page 7.

Observe important information → page 9. Insert large and small items of laundry. Do not trap items between the door and rubber seal.

**Adding detergent and care products**  
Measure according to: Amount of laundry, soiling, water hardness (ask your water supply company) and manufacturer's instructions. For models without insert for liquid detergent: Pour liquid detergent into the appropriate dispenser and place in the drum. Be careful when opening the detergent drawer while the machine is in operation.

Dilute viscous fabric softener and fabric conditioner with water. This prevents blockages.

## Programmes

Detailed overview of programmes → page 7. Temperature and spin speed can be selected individually, depending on the selected programme and programme progress.

<b>Cottons</b>	Hard-wearing fabrics
+ Prewash	Hard-wearing fabrics, prewash at 30 °C
<b>Easy-Care</b>	Easy-care fabrics
+ Prewash	Easy-care fabrics, prewash at 30 °C
<b>Mix Load</b>	Different types of laundry
<b>Delicate/Silk</b>	Delicate washable fabrics
<b>Wool</b>	Hand-/machine-washable wool
<b>Rinse</b>	Extra rinse with Spin
<b>Spin</b>	Extra spin with selectable spin speed
<b>Drain</b>	Drain the rinsing water when  is activated (Rinse Hold = no Final spin)
<b>Gentle Spin</b>	Extra spin with reduced spin speed
<b>SuperQuick 15*</b>	SuperQuick programme
<b>Sensitive</b>	Hard-wearing fabrics, longer washing and additional rinsing for particularly sensitive skin
<b>Sportswear</b>	Fabrics made from microfibre
<b>Dark Wash</b>	Dark-coloured fabrics

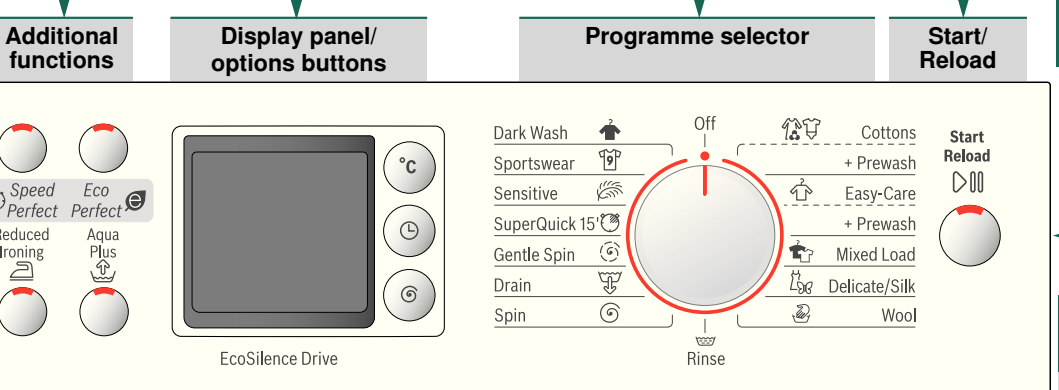

<b>Additional functions</b>	<b>Display panel/ options buttons</b>	<b>Programme selector</b>	<b>Start/Reload</b>
Speed Perfect, Eco Perfect, Reduced Ironing, Aqua Plus	Temperature, Programme end after, Rinse Hold, Childproof lock	Dark Wash, Sportswear, Sensitive, SuperQuick 15, Gentle Spin, Drain, Spin, Cottons, Easy-Care, Mixed Load, Delicate/Silk, Wool	Start/Reload
	Temperature: * -90 °C, °C, Select Temperatur (* = cold)		
	Programme end after: 1 - 24, Programme end after		
	Spin speed:  - 1600*,  Select the spin speed (* depending on the model) or  (Rinse Hold = no Final spin, laundry remains in the water after the final rinse).		
	Status indicators: Programme sequence indicators:     Wash, rinse, spin, programme duration or end		
	Rinse Hold reached		
	Childproof lock → page 5		

\*\*If the symbol flashes on the display panel, the Childlock is active → To deactivate, see page 5.

Additional functions and options buttons → Individual settings, page 5.

Programme selector for switching the machine on and off and for selecting the programme. Can be turned in either direction.

All buttons are sensitive and need only to be touched lightly. If you press and hold the (Finished in) option button, the appliance automatically runs through the settings options.

## Washing

Detergent drawer with compartments I, II, III  
Washing machine door  
Controlpanel  
Washing machine doorhandle  
Service flap

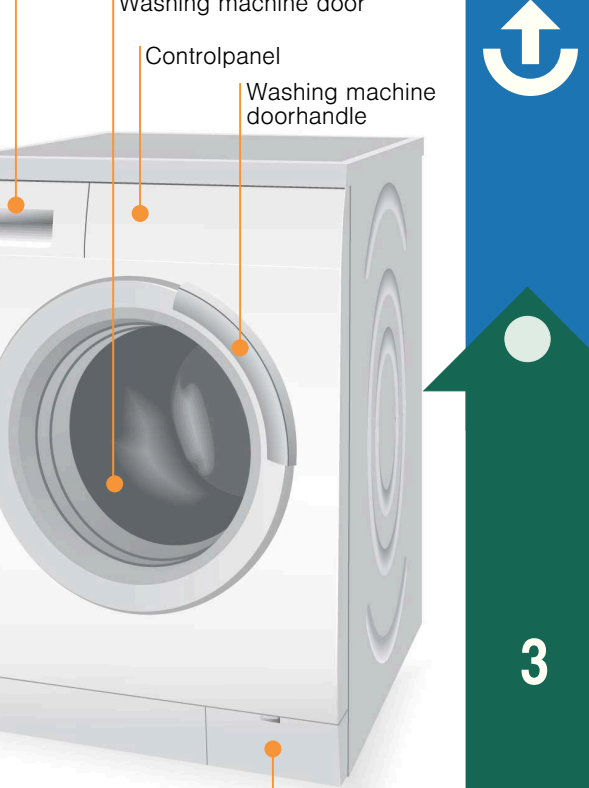

## Setting\*\* and adjusting programmes

Press Start/Reload

Programme selector for switching the machine on and off and for selecting the programme. Can be turned in either direction.

All buttons are sensitive and need only to be touched lightly. If you press and hold the (Finished in) option button, the appliance automatically runs through the settings options.

## Switch off the appliance

Turn the programme selector to **Off**.

## Turn the tap off

Not required for AquaStop models → Installation instructions, page 7.

## Remove the washing

Open the washing machine door and remove the washing. If (Rinse Hold) = no Final spin is active: Turn the programme selector to **Drain** or **Spin**. Select spin speed where necessary. Press Start/Reload.

Remove any foreign objects - risk of rusting.  
Leave the washing machine door and detergent drawer open so that any residual water can dry away.

## Programme has ended when ...

... Start/Reload is off and appears in the display panel.

## Cancel the programme

Programmes at high temperatures:  
- To cool the laundry down: Select **Rinse**.  
- Select Start/Reload.  
Programmes at lower temperatures:  
- Select **Spin** or **Drain**.  
- Select Start/Reload.

## Change the programme, if ...

... you have selected the wrong programme by mistake:  
- Reselect the programme.  
- Select Start/Reload. The new programme starts from scratch.

## Reloading laundry, if ... → page 5

Start/Reload is selected, and then **YES** lights up in the display panel and Start/Reload flashes. If **NO** lights up, the door cannot be opened.

Do not leave the washing machine door open for a prolonged period, as water from the laundry could leak out.

Select Start/Reload.

## Individual settings

### Options buttons

The spin speed and temperature can be changed before and during the selected programme runs. Effects depend on the programme progress.

### °C (Temperature)

The washing temperature displayed can be modified. The maximum washing temperature that can be selected depends on the programme that has been set.

### (Finished in)

When you select the programme, the relevant programme duration is displayed. You can delay the start of the programme before it begins. The "Finished in" time can be set in increments of one hour up to a maximum of 24 hours. Press the button repeatedly until the desired number of hours is displayed (h = hours). Select Start/Reload.

### (Spin speed) / (Rinse Hold = no Final spin)

You can change the spin speed displayed or select (Rinse Hold = no Final spin, laundry remains in the water after the final rinse display panel). The maximum selectable spin speed depends on the model and on which programme is currently selected.

### Additional functions → and overview of programmes, page 7

### SpeedPerfect

Washes in a shorter time but with a washing outcome comparable to that of the standard programme. Maximum load → Overview of programmes, page 7.

### EcoPerfect

For saving energy with a washing performance comparable to that of the standard programme.

### (Easy-iron)

Special spin sequence with subsequent fluffing. Gentle Final spin at reduced speed - residual moisture in the laundry slightly increased.

### (Aqua Plus)

Increased water level. Gentler treatment of the laundry..

### Childproof lock and reloading

You can lock the washing machine to prevent the functions you have set from being changed inadvertently.

## Individual settings

### Audible signal

1. Activate the mode for setting the signal volume

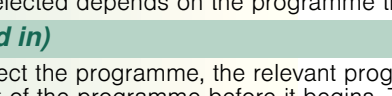

2. Set the volume for ...

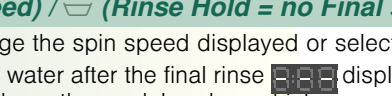

\* you may need to select the function several times.

### Start/Reload

To start the programme or to subsequently load additional laundry, and to activate/deactivate the childproof lock.

## Individual settings

### Audible signal

1. Activate the mode for setting the signal volume

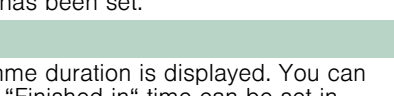

2. Set the volume for ...

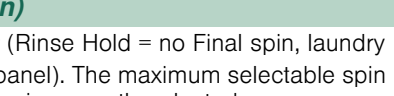

\* you may need to select the function several times.

### Start/Reload

To start the programme or to subsequently load additional laundry, and to activate/deactivate the childproof lock.

## Individual settings

### Audible signal

1. Activate the mode for setting the signal volume

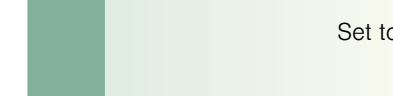

2. Set the volume for ...



\* you may need to select the function several times.

### Start/Reload

To start the programme or to subsequently load additional laundry, and to activate/deactivate the childproof lock.

## Overview of programmes

Check the consumption values table on page 8 and the instructions on page 9.

Programmes	°C	max.	Type of laundry	Additional functions; options; notes
<b>Cottons</b> + Prewash	* -90 °C	8 kg/ 5 kg*	Hard-wearing fabrics, heat-resistant fabrics made of cotton or linen	SpeedPerfect;  EcoPerfect;  (Rinse Hold)
<b>Sensitive</b>	* -60 °C		Hard-wearing fabrics made of cotton or linen	EcoPerfect;  (Rinse Hold); for particularly sensitive skin, longer washing at the selected temperature, higher water level, extra rinse
<b>Easy-Care</b> + Prewash	* -60 °C		Easy-care fabrics made of cotton, linen, synthetic fibres or blended fabrics	SpeedPerfect;  EcoPerfect;  (Rinse Hold)
<b>Mix Load</b>	* -40 °C	3.5 kg	Fabrics made of cotton or easy-care fabrics	SpeedPerfect;  EcoPerfect;  (Rinse Hold); different types of laundry can be washed together
<b>Dark Wash</b>	* -40 °C		Dark-coloured fabrics made of cotton and dark easy-care fabrics	SpeedPerfect;  EcoPerfect;  (Rinse Hold); reduced rinsing and Final spin
<b>Delicate/Silk</b>	* -40 °C		For delicate, washable fabrics, e.g. made of silk, satin, synthetic fibres or blended fabrics (e.g. curtains)	SpeedPerfect;  EcoPerfect;  (Rinse Hold); no spin cycles between the rinse cycles
<b>Wool</b>	* -40 °C	2 kg	Hand or machine-washable fabrics made of wool or containing wool	SpeedPerfect;  EcoPerfect;  (Rinse Hold); particularly gentle wash programme that prevents the laundry from shrinking, longer programme breaks fabrics rest in the detergent solution
<b>SuperQuick 15*</b>	* -40 °C		Easy-care fabrics made of cotton, linen, synthetic fibres or blended fabrics	SpeedPerfect;  EcoPerfect;  (Rinse Hold); short programme, approx. 15 minutes, suitable for lightly soiled laundry
<b>Sportswear</b>	* -40 °C		Fabrics made from microfibre	SpeedPerfect;  EcoPerfect;  (Rinse Hold)

## Additional programmes

reduced load with additional SpeedPerfect function. For a short programme, Mix Load 40 °C with max. spin speed is ideal. Programmes with no prewash - place detergent into compartment II, programmes with prewash - divide detergent between compartments I and II.

Additional programmes	°C	max.	Type of laundry	Additional functions; options; notes
<b>SpeedPerfect</b>	* -90 °C	8 kg/ 5 kg*	Hard-wearing fabrics, heat-resistant fabrics made of cotton or linen	SpeedPerfect;  EcoPerfect;  (Rinse Hold)
<b>EcoPerfect</b>	* -60 °C		Hard-wearing fabrics made of cotton or linen	EcoPerfect;  (Rinse Hold); for particularly sensitive skin, longer washing at the selected temperature, higher water level, extra rinse
<b>SpeedPerfect</b> + Prewash	* -60 °C		Easy-care fabrics made of cotton, linen, synthetic fibres or blended fabrics	SpeedPerfect;  EcoPerfect;  (Rinse Hold)
<b>Mix Load</b>	* -40 °C	3.5 kg	Fabrics made of cotton or easy-care fabrics	SpeedPerfect;  EcoPerfect;  (Rinse Hold); different types of laundry can be washed together
<b>Dark Wash</b>	* -40 °C		Dark-coloured fabrics made of cotton and dark easy-care fabrics	SpeedPerfect;  EcoPerfect;  (Rinse Hold); reduced rinsing and Final spin
<b>Delicate/Silk</b>	* -40 °C		For delicate, washable fabrics, e.g. made of silk, satin, synthetic fibres or blended fabrics (e.g. curtains)	SpeedPerfect;  EcoPerfect;  (Rinse Hold); no spin cycles between the rinse cycles
<b>Wool</b>	* -40 °C	2 kg	Hand or machine-washable fabrics made of wool or containing wool	SpeedPerfect;  EcoPerfect;  (Rinse Hold); particularly gentle wash programme that prevents the laundry from shrinking, longer programme breaks fabrics rest in the detergent solution
<b>SuperQuick 15*</b>	* -40 °C		Easy-care fabrics made of cotton, linen, synthetic fibres or blended fabrics	SpeedPerfect;  EcoPerfect;  (Rinse Hold); short programme, approx. 15 minutes, suitable for lightly soiled laundry
<b>Sportswear</b>	* -40 °C		Fabrics made from microfibre	SpeedPerfect;  EcoPerfect;  (Rinse Hold)

## Additional programmes

reduced load with additional SpeedPerfect function. For a short programme, Mix Load 40 °C with max. spin speed is ideal. Programmes with no prewash - place detergent into compartment II, programmes with prewash - divide detergent between compartments I and II.

Additional programmes	°C	max.	Type of laundry	Additional functions; options; notes
<b>SpeedPerfect</b>	* -90 °C	8 kg/ 5 kg*	Hard-wearing fabrics, heat-resistant fabrics made of cotton or linen	SpeedPerfect;  EcoPerfect;  (Rinse Hold)
<b>EcoPerfect</b>	* -60 °C		Hard-wearing fabrics made of cotton or linen	EcoPerfect;  (Rinse Hold); for particularly sensitive skin, longer washing at the selected temperature, higher water level, extra rinse
<b>SpeedPerfect</b> + Prewash	* -60 °C		Easy-care fabrics made of cotton, linen, synthetic fibres or blended fabrics	SpeedPerfect;  EcoPerfect;  (Rinse Hold)
<b>Mix Load</b>	* -40 °C	3.5 kg	Fabrics made of cotton or easy-care fabrics	SpeedPerfect;  EcoPerfect;  (Rinse Hold); different types of laundry can be washed together
<b>Dark Wash</b>	* -40 °C		Dark-coloured fabrics made of cotton and dark easy-care fabrics	SpeedPerfect;  EcoPerfect;  (Rinse Hold); reduced rinsing and Final spin
<b>Delicate/Silk</b>	* -40 °C		For delicate, washable fabrics, e.g. made of silk, satin, synthetic fibres or blended fabrics (e.g. curtains)	SpeedPerfect;  EcoPerfect;  (Rinse Hold); no spin cycles between the rinse cycles
<b>Wool</b>	* -40 °C	2 kg	Hand or machine-washable fabrics made of wool or containing wool	SpeedPerfect;  EcoPerfect;  (Rinse Hold); particularly gentle wash programme that prevents the laundry from shrinking, longer programme breaks fabrics rest in the detergent solution
<b>SuperQuick 15*</b>	* -40 °C		Easy-care fabrics made of cotton, linen, synthetic fibres or blended fabrics	SpeedPerfect;  EcoPerfect;  (Rinse Hold); short programme, approx. 15 minutes, suitable for lightly soiled laundry
<b>Sportswear</b>	* -40 °C		Fabrics made from microfibre	SpeedPerfect;  EcoPerfect;  (Rinse Hold)

## Additional programmes

reduced load with additional SpeedPerfect function. For a short programme, Mix Load 40 °C with max. spin speed is ideal. Programmes with no prewash - place detergent into compartment II, programmes with prewash - divide detergent between compartments I and II.

Additional programmes	°C	max.	Type of laundry	Additional functions; options; notes
<b>SpeedPerfect</b>	* -90 °C	8 kg/ 5 kg*	Hard-wearing fabrics, heat-resistant fabrics made of cotton or linen	SpeedPerfect;  EcoPerfect;  (Rinse Hold)
<b>EcoPerfect</b>	* -60 °C		Hard-wearing fabrics made of cotton or linen	EcoPerfect;  (Rinse Hold); for particularly sensitive skin, longer washing at the selected temperature, higher water level, extra rinse
<b>SpeedPerfect</b> + Prewash	* -60 °C		Easy-care fabrics made of cotton, linen, synthetic fibres or blended fabrics	SpeedPerfect;  EcoPerfect;  (Rinse Hold)
<b>Mix Load</b>	* -40 °C	3.5 kg	Fabrics made of cotton or easy-care fabrics	SpeedPerfect;  EcoPerfect;  (Rinse Hold); different types of laundry can be washed together
<b>Dark Wash</b>	* -40 °C		Dark-coloured fabrics made of cotton and dark easy-care fabrics	SpeedPerfect;  EcoPerfect;  (Rinse Hold); reduced rinsing and Final spin
<b>Delicate/Silk</b>	* -40 °C		For delicate, washable fabrics, e.g. made of silk, satin, synthetic fibres or blended fabrics (e.g. curtains)	SpeedPerfect;  EcoPerfect;  (Rinse Hold); no spin cycles between the rinse cycles
<b>Wool</b>	* -40 °C	2 kg	Hand or machine-washable fabrics made of wool or containing wool	SpeedPerfect;  EcoPerfect;

# Safety instructions

- Read the Instruction manual and Installation instructions and all other information enclosed with the washing machine and act accordingly.
- Retain the documents for subsequent use.
- Risk of electric shock**
  - Never pull the cable to disconnect the mains plug.
  - Only insert/pull out the mains plug with dry hands.
- Danger to life**

For worn-out appliances:

  - Disconnect the mains plug.
  - Sever the mains cable and discard along with the plug.
  - Destroy the lock on the washing machine door. This will prevent children from locking themselves in and putting their lives in danger.
- Danger of suffocation**
  - Keep packaging, film and packaging parts out of the reach of children.
- Risk of poisoning**
  - Keep detergents and care products out of the reach of children.
- Risk of explosion**
  - Items of laundry pretreated with cleaning agents containing solvents, e.g. stain remover/cleaning solvent may cause an explosion after being loaded into the washing machine. Rinse items of laundry thoroughly by hand before washing.
- Risk of injury**
  - The washing machine door can become very hot.
  - Be careful when draining hot detergent solution.
  - Do not climb onto the washing machine.
  - Do not lean on the open washing machine door.
  - Do not reach into the drum if it is still rotating.

# Consumption values

Programme	Additional function	Load	Electricity consumption***	Water***	Programme duration***
Cottons 30 °C**		8 kg	0.35 kWh	76 l	2:20 h
Cottons 40 °C**		8 kg	0.97 kWh	76 l	2:30 h
Cottons 60 °C**		8 kg	1.47 kWh	76 l	2:40 h
Cottons 60 °C	EcoPerfect*	8 kg	1.03 kWh	56 l	3:25 h
Cottons 90 °C		8 kg	2.34 kWh	87 l	2:30 h
Mix Load 40 °C**		3.5 kg	0.47 kWh	49 l	1:01 h
Easy-Care 40 °C**		3.5 kg	0.55 kWh	55 l	1:43 h
Delicate/Silk 30 °C (cold)		2 kg	0.04 kWh	35 l	0:41 h
Delicate/Silk 30 °C		2 kg	0.14 kWh	35 l	0:41 h
Wool (cold)		2 kg	0.06 kWh	40 l	0:40 h
Wool 30 °C		2 kg	0.16 kWh	40 l	0:40 h

\* Programme setting for testing and energy labelling in accordance with EU directive 92/75/EEC.  
 \*\* Programme setting for testing with the currently valid version of EN60456.  
 \*\*\* Note for comparative testing: to test using the specified load amount and maximum spin speed. Select the **Mix Load 40 °C** programme and maximum spin speed as the **short programme** for coloureds.  
 \*\*\*\* The values deviate from the indicated values depending on water pressure, hardness, and inlet temperature, ambient temperature, type, amount and soiling of the laundry, detergent used, fluctuations in the power supply and selected additional functions.

# Important information

- Before washing for the first time**

Do not load any laundry into the machine. Turn on the tap. Add the following to compartment II:

  - approx. 1 litre water
  - detergent (dosage according to the manufacturer's instructions for light soiling and the appropriate degree of water hardness)

Set the programme selector to **Easy-Care 60 °C** and select **Start/Reload**. At the end of the programme, turn the programme selector to **Off**.
- Protecting the laundry and the machine**
  - Empty pockets.
  - Look out for metal items (paperclips, etc.).
  - Wash delicates in a laundry bag (tights, curtains, underwired bras).
  - Fasten zips, do up any buttons.
  - Brush sand out of pockets and collars.
  - Remove curtain fittings or place in the laundry bag.
- Loading the laundry**

Insert large and small items of laundry. Take care not to trap items of laundry between the washing machine door and the rubber seal.
- Laundry with varying degrees of soiling**

Wash new items of clothing separately.

  - light: No prewash. The **SpeedPerfect** function can also be selected if desired.
  - medium: Pretreat any stains as necessary.
  - heavy: Insert less laundry. Select Prewash with the programme.
- Soaking**

Load laundry of the same colour

Pour soaking agent/detergent into compartment II in accordance with the manufacturer's instructions. Turn the programme selector to **Cottons 30 °C** and press **Start/Reload**. After approx. 10 minutes, press **Start/Reload** to pause the programme. Once the required soaking time has elapsed, press **Start/Reload** again to continue the programme, or select a different programme.
- Starching**

Laundry must not be treated with fabric softener

Starching is possible in all wash programmes using liquid starch. Pour the starch into the fabric softener compartment according to the manufacturer's instructions (if necessary clean it first).
- Dyeing/bleaching**

Dye should only be used in normal household quantities. Salt may damage stainless steel. Always follow the dye manufacturer's instructions. **Do not** bleach laundry in the washing machine.

**Insert for liquid detergent** model-dependent

Position the insert for dispensing liquid detergent:

- Remove the detergent drawer completely -> [page 10](#).
- Slide the insert forwards.

Do not use the insert (slide upwards):

- for gel detergents and washing powder,
- for programmes with **+ Prewash** or the **(Finished in)** option

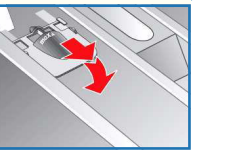

**Care**

- Machine housing, control panel**
  - Wipe with a soft, damp cloth.
  - Do not use any abrasive cloths, scourers or cleaning agents (stainless steel cleaners).
  - Remove detergent and cleaning agent residue immediately.
  - Do not clean with a jet of water.

**Cleaning the detergent drawer ...**

... if it contains detergent or fabric softener residues.

- Pull out, press insert down, remove drawer completely.
- To remove the insert, push the insert up from below with your finger.
- Clean the detergent dispenser tray and insert with water and a brush and dry it.
- Attach the insert and engage (connect the cylinder to the guide pin).
- Push in the detergent drawer.

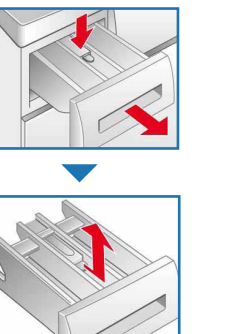

**Drum**

Leave the washing machine door open so that the drum can dry out. Rust stains - use chlorine-free cleaning agent, not steel wool.

**Descaling** Ensure there is no laundry in the machine

This is not necessary if the detergent is dosed correctly. However, if it is necessary, follow the instructions of the descaler manufacturer. Suitable descaling products can be purchased from our website or after-sales service -> [page 13](#).

**Information on the display panel** depending on model

F: 16	Close the door properly; laundry may be trapped.
F: 17 , 29	Open the tap fully, supply hose kinked/trapped; clean the filter -> <a href="#">page 11</a> , water pressure too low.
F: 18	Detergent solution pump blocked; clean detergent solution pump -> <a href="#">page 11</a> . Drainage hose/waste pipe blocked; clean the drain hose on the siphon -> <a href="#">page 11</a> .
F: 23	Water in the base tub, appliance leaking. Call the after-sales service.
F: 34	Cannot lock washing machine door. Open the door and close it again so that you can hear it "click"; switch the appliance off and on again; set the programme and make individual settings; start the programme.
Other displays	Switch off the appliance, wait 5 seconds and switch on again. If the same display appears again, call the after-sales service -> <a href="#">page 13</a> .

# Information about blockages

- Detergent solution pump**

Turn the programme selector to **Off**, disconnect the mains plug.

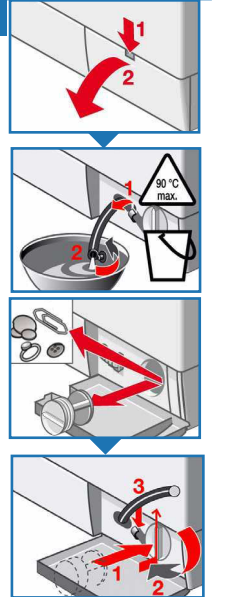
  - Open and remove the service flap.
  - Remove the drainage hose from its holder. Remove the sealing cap and allow the solution to drain out. Put the sealing cap back in place.
  - Unscrew the pump cover carefully (residual water).
  - Clean the interior, pump cover thread and pump housing (the impeller in the detergent solution pump must be able to rotate).
  - Put the pump cover back in place and screw it tight. The handle should stand vertically. Insert the drainage hose into its holder.
  - Refit the service flap and close it.
- Drainage hose at the siphon**

Turn the programme selector to **Off**, disconnect the mains plug.

  - Loosen the hose clamp, remove the drainage hose carefully (residual water).
  - Clean the drainage hose and siphon connecting piece.
  - Reattach the drainage hose and secure the connection with the hose clamp.
- Filter in the water supply**

**Risk of electric shock**  
Do not immerse the AquaStop safety device in water (it contains an electric valve).

Reduce the water pressure in the supply hose:

  - Turn off the tap.
  - Select any programme (apart from **Spin/ Drain**).
  - Press **Start/Reload**. Allow the programme to run for approx. 40 seconds.
  - Turn the programme selector to **Off**. Remove the mains plug from the socket. To clean the filter:
  - Disconnect the hose from the tap. Clean the filter using a small brush.
  - Connect the hose and check for leaks.

**and/or** for Standard and Aqua-Secure models: Remove the hose from the back of the appliance. Remove the filter using pliers and clean the filter.

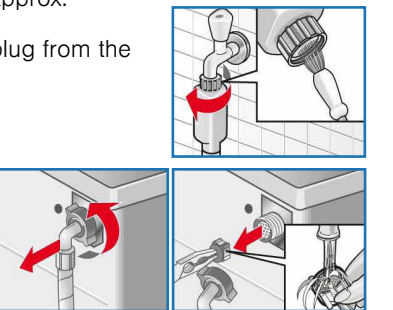

**What to do if ...**

- Water is leaking out.
  - Attach/replace the drainage hose correctly.
  - Tighten the screw connection of the supply hose.
- No water supply. Detergent not dispensed.
  - Start/Reload** not selected?
  - Tap not turned on?
  - Filter may be blocked. Clean the filter -> [page 11](#).
  - Supply hose kinked or trapped?
- Washing machine door cannot be opened.
  - Safety function active. Programme terminated? -> [page 4](#).
  - (Rinse Hold) = without Final spin selected? -> [page 3,4](#).
  - Can be opened by emergency release only? -> [page 13](#).
- Programme does not start.
  - Start/Reload** or (Finished in) time selected?
  - Washing machine door closed?
  - Childlock active? Deactivate it -> [page 5](#).
- Detergent solution does not drain.
  - (Rinse Hold) = without Final spin selected? -> [page 3,4](#).
  - Clean the detergent solution pump -> [page 11](#).
  - Clean the waste pipe and/or drainage hose.
- Water not visible in the drum.
  - Not a fault - water below the visible area.
- Unsatisfactory spin result. Laundry wet/too damp.
  - Not a fault - the unbalanced-load detection system has cancelled the spin cycle because of uneven distribution of the laundry. Distribute small and large items of laundry evenly inside the drum.
  - (Easy-iron) selected? -> [page 5](#).
  - Selected speed too low? -> [page 5](#).
- Drum spins gently several times.
  - Not a fault - unbalanced-load detection system is adjusting the imbalance.
- Residual water in the compartment for care products.
  - Not a fault - the action of the care product is not affected.
  - Clean the insert if necessary -> [page 10](#).
- Odour formation in the washing machine.
  - Run the **Cottons 90 °C** programme with no load inserted. Use standard detergent.
- Status display flashes. Appliance has detected a detergent overload.
  - Too much detergent used? Mix 1 tablespoon of fabric softener with 1/2 litre water and pour into compartment II (not with outdoor or down fabrics).
  - Reduce the detergent dosage for the next wash cycle.
- Loud spinning, vibrations and "walking" during the spin cycle.
  - Appliance feet fixed? Secure the appliance feet -> [Installation instructions](#).
  - Transport braces removed? Remove the transport braces -> [Installation instructions](#).
- Display panel/indicator lamps do not function during operation.
  - Power cut?
  - Circuit breakers tripped? Reset/replace the circuit breakers.
  - If the fault occurs repeatedly, call the after-sales service.
- Programme sequence longer than usual.
  - Not a fault - unbalanced-load detection system is adjusting the imbalance by repeatedly redistributing the laundry.
  - Not a fault - foam detection system active - adds an additional rinse cycle.
- Detergent residues on the laundry.
  - Occasionally, phosphate-free detergents contain water-insoluble residues.
  - Use the **Rinse** cycle or brush out the laundry after washing.

# What to do if ...

- in Reload mode, **Start/Reload** flashes very quickly and an audible signal sounds
  - Water level too high. Not possible to reload laundry. Close door immediately if open.
  - To continue the programme, press **Start/Reload**.
- If you cannot correct a fault yourself (switching on/off) or a repair is required:
  - Turn the programme selector to **Off** and remove the mains plug from the socket.
  - Turn off the water supply and call the after-sales service -> [page 13](#).

**Emergency release** e.g. in the event of a power cut

The programme continues when the power supply is restored. However, if the laundry has to be removed, the washing machine door can be opened as follows:

**Risk of scalding.**  
The detergent solution and laundry may be hot. Allow them to cool down. Do not reach inside the drum if it is still turning. Do not open the door if you can see water through the glass.

- Turn the programme selector to **Off** and disconnect the mains plug.
- Drain the detergent solution -> [page 11](#).
- Pull the emergency release downwards with a tool and release. Washing machine door can then be opened.



# What to do if ...

- The programme continues when the power supply is restored. However, if the laundry has to be removed, the washing machine door can be opened as follows:
- Risk of scalding.**  
The detergent solution and laundry may be hot. Allow them to cool down. Do not reach inside the drum if it is still turning. Do not open the door if you can see water through the glass.

**After-sales service**

- If you cannot rectify the fault yourself (Troubleshooting -> [page 12, 13](#)), please contact our after-sales service. We will always find a suitable solution and will avoid a visit from a service technician wherever possible.
- You can find the contact details for your nearest after-sales service here or in the after-sales service directory (depending on model).
- GB** 0844 8928979 (Calls from a BT landline will be charged at up to 3 pence per minute. A call set-up fee of up to 6 pence may apply).
- IE** 01450 2655
- Please give the after-sales service the product number (E-Nr.) and the production number (FD) of the appliance.

You will find this information: on the inside of the washing machine door\*/opened service flap\* and rear of the appliance. \*depending on the model

E-Nr. \_\_\_\_\_ FD \_\_\_\_\_

Product number      Production number

- Rely on the professionalism of the manufacturer.** Please contact us. This will ensure that the repair is carried out by trained service technicians who arrive equipped with genuine spare parts for your appliance.

# What to do if ...

- in Reload mode, **Start/Reload** flashes very quickly and an audible signal sounds
  - Water level too high. Not possible to reload laundry. Close door immediately if open.
  - To continue the programme, press **Start/Reload**.
- If you cannot correct a fault yourself (switching on/off) or a repair is required:
  - Turn the programme selector to **Off** and remove the mains plug from the socket.
  - Turn off the water supply and call the after-sales service -> [page 13](#).

**After-sales service**

- If you cannot rectify the fault yourself (Troubleshooting -> [page 12, 13](#)), please contact our after-sales service. We will always find a suitable solution and will avoid a visit from a service technician wherever possible.
- You can find the contact details for your nearest after-sales service here or in the after-sales service directory (depending on model).
- GB** 0844 8928979 (Calls from a BT landline will be charged at up to 3 pence per minute. A call set-up fee of up to 6 pence may apply).
- IE** 01450 2655
- Please give the after-sales service the product number (E-Nr.) and the production number (FD) of the appliance.

You will find this information: on the inside of the washing machine door\*/opened service flap\* and rear of the appliance. \*depending on the model

E-Nr. \_\_\_\_\_ FD \_\_\_\_\_

Product number      Production number

- Rely on the professionalism of the manufacturer.** Please contact us. This will ensure that the repair is carried out by trained service technicians who arrive equipped with genuine spare parts for your appliance.



**Washing machine**



**Instruction manual**



**Observe the safety instructions on page 8.**

Read these instructions and the separate installation instructions before operating the washing machine.

# Your washing machine

**Congratulations** - you have opted for a modern, high-quality domestic appliance manufactured by Bosch. This washing machine is distinguished by its economical water and energy consumption. Each machine that leaves our factory is inspected thoroughly to ensure that it functions properly and is in perfect condition.

For further information about products, accessories, spare parts and services visit our web site [www.bosch-home.com](http://www.bosch-home.com) or contact our after-sales service centres.

## Contents

	Page
Intended use .....	1
Programmes .....	1
Setting and adjusting the programme .....	3
Washing .....	3/4
After washing .....	4
Individual settings .....	5/6
Overview of programmes .....	7
Safety instructions .....	8
Consumption values .....	8
Important information .....	9
Insert for liquid detergent .....	10
Care .....	10
Information on the display panel .....	10
Instructions for blockages .....	11
What to do if .....	12
Emergency release .....	13
After-sales service .....	13



### Environmental protection/Conservation tips

- Always fill the washing machine with a maximum amount of laundry for the relevant programme.
- Wash normally soiled laundry without a prewash.
- Instead of **Cottons 90 °C**, select the **Cottons 60 °C** programme along with the additional **EcoPerfect** function. Comparable cleaning with significantly lower energy consumption.
- Measure the detergent according to the manufacturer's instructions and water hardness.
- If the laundry is then dried in the tumble dryer, select the appropriate spin speed according to the instructions of the dryer manufacturer.

## Intended use

- For domestic use only
- for machine-washable fabrics and hand-washable wool in detergent solution,
- To be operated with cold mains water and commercially available detergents and care products which are suitable for use in washing machines.

- Do not leave children unattended near the washing machine
- The washing machine is not to be used by children or persons not familiar with the operating instructions
- Keep pets away from the washing machine.

### Programmes

Detailed overview of programmes → page 7.  
Temperature and spin speed can be selected individually, depending on the selected programme and programme progress.

<b>Cottons</b>	Hard-wearing fabrics
+ Prewash	Hard-wearing fabrics, prewash at 30 °C
<b>Easy-Care</b>	Easy-care fabrics
+ Prewash	Easy-care fabrics, prewash at 30 °C
<b>Mix Load</b>	Different types of laundry
<b>Delicate/Silk</b>	Delicate washable fabrics
<b>Wool</b>	Hand/machine-washable wool
<b>Rinse</b>	Extra rinse with Spin
<b>Spin</b>	Extra spin with selectable spin speed
<b>Drain</b>	Drain the rinsing water when  is activated (Rinse Hold = no Final spin)
<b>Gentle Spin</b>	Extra spin with reduced spin speed
<b>SuperQuick 15'</b>	SuperQuick programme
<b>Sensitive</b>	Hard-wearing fabrics, longer washing and additional rinsing for particularly sensitive skin
<b>Sportswear</b>	Fabrics made from microfibre
<b>Dark Wash</b>	Dark-coloured fabrics

## Preparation



Correct installation according to the separate installation instructions.



### Check the machine

- Never use a damaged machine.
- Inform the after-sales service.



### Connect the mains plug

- Make sure your hands are dry.
- Take hold of the plug only.



### Turn the tap on

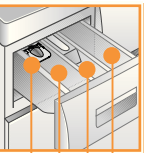

Insert for liquid detergent (depending on model), page 10

**Compartment II:** detergent for main wash, water softener, bleach, stain remover

**Compartment** : fabric softener, starch

**Compartment I:** detergent for Prewash

**Additional functions**

**Display panel/ options buttons**

**Programme**

- 90 °C	°C	Select Temperatur (* = cold)
1 - 24		Programme end after
- 1600*		Select the spin speed (* depends on programme or  (Rinse Hold = no Final spin water after the final rinse).
Status indicators		Programme sequence indicators
		Wash, rinse, spin, programme
		Rinse Hold reached
		Childproof lock → page 5

*Before washing for the first time*  
Wash once without any laundry → page 9.

## Sorting and loading the laundry

Please note the manufacturer's care information. According to the information on the care labels. According to type, colour, soiling and temperature. Do not exceed the maximum load → page 7.

Observe important information → page 9.  
Insert large and small items of laundry.

Close the door. Ensure that items are not trapped between the door and rubber seal.

## Adding detergent and care products

Measure according to: amount of laundry, soiling, water hardness (ask your water supply company) and manufacturer's instructions.

For models without insert for liquid detergent: Pour liquid detergent into the appropriate dispenser and place in the drum. Be careful when opening the detergent drawer while the machine is in operation.

**i** Dilute viscous fabric softener and fabric conditioner with water. This prevents blockages.

## Setting\*\* and adjusting programmes

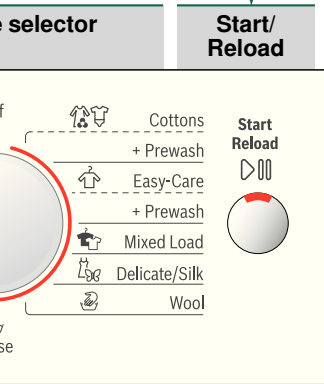

**i** \*\*If the **---** symbol flashes on the display panel, the Childlock is active → To deactivate, see page 5.  
Additional functions and options buttons → Individual settings, page 5.

**Press** **▶||| Start/Reload**

**i** Programme selector for switching the machine on and off and for selecting the programme. Can be turned in either direction.

**i** All buttons are sensitive and need only to be touched lightly. If you press and hold the **⏸** (Finished in) option button, the appliance automatically runs through the settings options.

# Washing

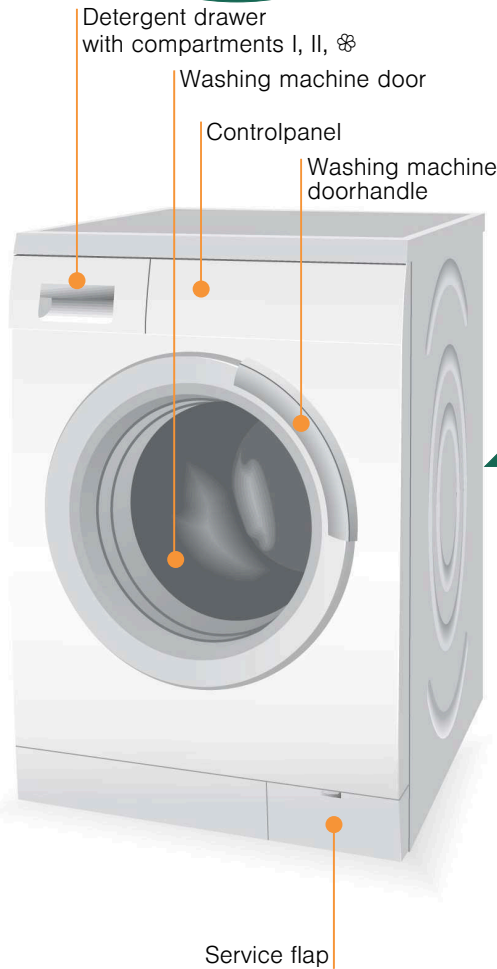

# Washing

## Switch off the appliance

Turn the programme selector to **Off**.

## Turn the tap off

Not required for AquaStop models → Installation instructions, page 7.

## Remove the washing

Open the washing machine door and remove the washing. If **☹** (Rinse Hold) = no Final spin is active: Turn the programme selector to **☹ Drain** or **⊖ Spin**. Select spin speed where necessary. Press **▶||| Start/Reload**.

**i** – Remove any foreign objects - risk of rusting.  
– Leave the washing machine door and detergent drawer open so that any residual water can dry away.

## Programme has ended when ...

... **▶||| Start/Reload** is off and **---** appears in the display panel.

## Cancel the programme

Programmes at high temperatures:  
– To cool the laundry down: Select **☹ Rinse**.  
– Select **▶||| Start/Reload**.  
Programmes at lower temperatures:  
– Select **⊖ Spin** or **☹ Drain**.  
– Select **▶||| Start/Reload**.

## Change the programme, if ...

... you have selected the wrong programme by mistake:  
– Reselect the programme.  
– Select **▶||| Start/Reload**. The new programme starts from scratch.

## Reloading laundry, if ... → page 5

**▶||| Start/Reload** is selected, and then **YES** lights up in the display panel and **▶||| Start/Reload** flashes. If **NO** lights up, the door cannot be opened.

**i** Do not leave the washing machine door open for a prolonged period, as water from the laundry could leak out.

Select **▶||| Start/Reload**.

# Individual settings

## Options buttons

The spin speed and temperature can be changed before and during the selected programme runs. Effects depend on the programme progress.

## °C (Temperature)

The washing temperature displayed can be modified. The maximum washing temperature that can be selected depends on the programme that has been set.

## ⌚ (Finished in)

When you select the programme, the relevant programme duration is displayed. You can delay the start of the programme before it begins. The "Finished in" time can be set in increments of one hour up to a maximum of 24 hours. Press the ⌚ button repeatedly until the desired number of hours is displayed (h = hours). Select **Start/Reload**.

## ⦿ (Spin speed) / ☒ (Rinse Hold = no Final spin)

You can change the spin speed displayed or select ☒ (Rinse Hold = no Final spin, laundry remains in the water after the final rinse **RRR** display panel). The maximum selectable spin speed depends on the model and on which programme is currently selected.

## Additional functions → and overview of programmes, page 7

**SpeedPerfect** Washes in a shorter time but with a washing outcome comparable to that of the standard programme. Maximum load → Overview of programmes, page 7.

**EcoPerfect** For saving energy with a washing performance comparable to that of the standard programme.

**(Easy-iron)** Special spin sequence with subsequent fluffing. Gentle Final spin at reduced speed - residual moisture in the laundry slightly increased.

**(Aqua Plus)** Increased water level. Gentler treatment of the laundry..

## Childproof lock and reloading

You can lock the washing machine to prevent the functions you have set from being changed inadvertently.

### Childlock/ appliance lock

**Activation/Deactivation:** After the programme has started/finished, press and hold **Start/Reload** for 5 seconds.

Note: the Childlock remains activated until the start of the next programme, even after the machine has been switched off.

Then deactivate the Childlock after the machine has been switched back on.

### YES Reload

If you want to add subsequent items of laundry after the programme has started, press **Start/Reload**. The machine checks whether reloading is possible.

If **YES** lights up and **Start/Reload** flashes, reloading is possible.

**NO** flashing: wait until **YES** lights up.

Note: do not open the door until **YES** lights up.

**NO:** reloading not possible.

Note: for safety reasons, the washing machine door remains locked when the water level and/or temperature is high, or during a spin cycle.

To continue the programme, press **Start/Reload**.

# Individual settings

## Audible signal

1. Activate the mode for setting the signal volume

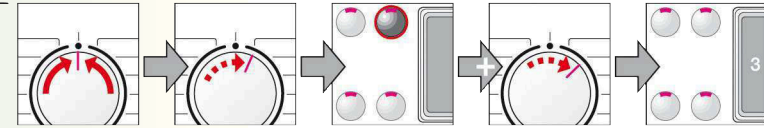

Set to • 1 step, the display panel lights up Press and hold + 1 step, release

2. Set the volume for ...

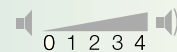

\* you may need to select the function several times.

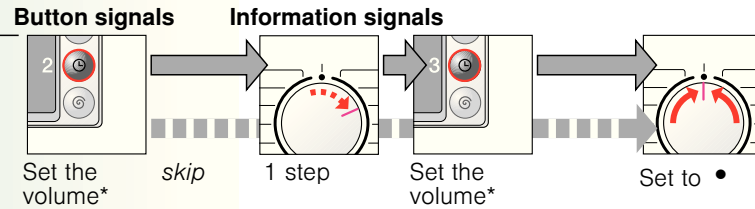

## Start/Reload

To start the programme or to subsequently load additional laundry, and to activate/deactivate the childproof lock.

# Overview of programmes → Check the consumption values table on page 8 and the instructions on page 9.



## Type of laundry

max.

Programmes

°C

## Additional functions; options; notes

Programmes	°C	max.	Type of laundry	Additional functions; options; notes
<b>Cottons</b> + Prewash	* - 90 °C	8 kg/ 5 kg*	Hard-wearing fabrics, heat-resistant fabrics made of cotton or linen	<b>SpeedPerfect</b> , <b>EcoPerfect</b> ,  (Reduced-Ironing),  (Aqua Plus),  (Rinse Hold)
<b>Sensitive</b>	* - 60 °C		Hard-wearing fabrics made of cotton or linen	<b>SpeedPerfect</b> , <b>EcoPerfect</b> ,  (Reduced-Ironing),  (Aqua Plus); for particularly sensitive skin, longer washing at the selected temperature, higher water level, extra rinse
<b>Easy-Care</b> + Prewash	* - 60 °C		Easy-care fabrics made of cotton or linen, synthetic fibres or blended fabrics	<b>SpeedPerfect</b> , <b>EcoPerfect</b> ,  (Reduced-Ironing),  (Aqua Plus)
<b>Mix Load</b>	* - 40 °C	3.5 kg	Fabrics made of cotton or easy-care fabrics	<b>SpeedPerfect</b> , <b>EcoPerfect</b> ,  (Reduced-Ironing),  (Aqua Plus); different types of laundry can be washed together
<b>Dark Wash</b>	* - 40 °C		Dark-coloured fabrics made of cotton and dark easy-care fabrics	<b>SpeedPerfect</b> , <b>EcoPerfect</b> ,  (Reduced-Ironing),  (Aqua Plus); reduced rinsing and Final spin
<b>Delicate/Silk</b>	* - 40 °C		For delicate, washable fabrics, e.g. made of silk, satin, synthetic fibres or blended fabrics (e.g. curtains)	<b>SpeedPerfect</b> , <b>EcoPerfect</b> ,  (Reduced-Ironing),  (Aqua Plus); no spin cycles between the rinse cycles
<b>Wool</b>	* - 40 °C	2 kg	Hand or machine-washable fabrics made of wool or containing wool	(Rinse Hold); particularly gentle wash programme that prevents the laundry from shrinking, longer programme breaks (fabrics rest in the detergent solution)
<b>SuperQuick 15'</b>	* - 40 °C		Easy-care fabrics made of cotton, linen, synthetic fibres or blended fabrics	(Rinse Hold); short programme, approx. 15 minutes, suitable for lightly soiled laundry
<b>Sportswear</b>	* - 40 °C		Fabrics made from microfibre	<b>SpeedPerfect</b> , <b>EcoPerfect</b> ,  (Reduced-Ironing),  (Aqua Plus)

### Additional programmes

\* reduced load with additional **SpeedPerfect** function.

i For a **short programme** with **max. spin speed is ideal**.

Programmes with no prewash - place detergent into compartment **II**, programmes with prewash - divide detergent between compartments **I** and **II**.

**Rinse**, **Spin**, **Drain**, **Gentle Spin**

1209 / 9000522641



WAS32462GB  
WAS28462GB  
WAS24462GB

Robert Bosch Hausgeräte GmbH  
Carl-Wery-Str. 34  
81739 München / Deutschland



## Safety instructions

- Read the Instruction manual and Installation instructions and all other information enclosed with the washing machine and act accordingly.
- Retain the documents for subsequent use.

**Risk of electric shock** – Never pull the cable to disconnect the mains plug.  
– Only insert/pull out the mains plug with dry hands.

**Danger to life** For worn-out appliances:  
– Disconnect the mains plug.  
– Sever the mains cable and discard along with the plug.  
– Destroy the lock on the washing machine door. This will prevent children from locking themselves in and putting their lives in danger.

**Danger of suffocation** – Keep packaging, film and packaging parts out of the reach of children.

**Risk of poisoning** – Keep detergents and care products out of the reach of children.

**Risk of explosion** – Items of laundry pretreated with cleaning agents containing solvents, e.g. stain remover/cleaning solvent may cause an explosion after being loaded into the washing machine.  
Rinse items of laundry thoroughly by hand before washing.

**Risk of injury** – The washing machine door can become very hot.  
– Be careful when draining hot detergent solution.  
– Do not climb onto the washing machine.  
– Do not lean on the open washing machine door.  
– Do not reach into the drum if it is still rotating.

## Consumption values

Programme	Additional function	Load	Electricity consumption***	Water***	Programme duration***
Cottons  30 °C**		8 kg	0.35 kWh	76 l	2:20 h
Cottons  40 °C**		8 kg	0.97 kWh	76 l	2:30 h
Cottons  60 °C**		8 kg	1.47 kWh	76 l	2:40 h
Cottons  60 °C	EcoPerfect*	8 kg	1.03 kWh	56 l	3:25 h
Cottons  90 °C		8 kg	2.34 kWh	87 l	2:30 h
Mix Load  40 °C**		3.5 kg	0.47 kWh	49 l	1:01 h
Easy-Care  40 °C**		3.5 kg	0.55 kWh	55 l	1:43 h
Delicate/Silk  (cold)		2 kg	0.04 kWh	35 l	0:41 h
Delicate/Silk  30 °C		2 kg	0.14 kWh	35 l	0:41 h
Wool  (cold)		2 kg	0.06 kWh	40 l	0:40 h
Wool 30 °C		2 kg	0.16 kWh	40 l	0:40 h

\* Programme setting for testing and energy labelling in accordance with EU directive 92/75/EEC.

\*\* Programme setting for testing with the currently valid version of EN60456.

Note for comparative testing: to test using the test programmes, wash using the specified load amount and maximum spin speed.

Select the Mix Load 40 °C programme and maximum spin speed as the **short programme** for coloureds.

\*\*\* The values deviate from the indicated values depending on water pressure, hardness, and inlet temperature, ambient temperature, type, amount and soiling of the laundry, detergent used, fluctuations in the power supply and selected additional functions.



## Important information



### Before washing for the first time

Do not load any laundry into the machine. Turn on the tap.

Add the following to compartment **II**:

- approx. 1 litre water
- detergent (dosage according to the manufacturer's instructions for light soiling and the appropriate degree of water hardness)

Set the programme selector to Easy-Care 60 °C and select Start/Reload.

At the end of the programme, turn the programme selector to **Off**.



### Protecting the laundry and the machine

- Empty pockets.
- Look out for metal items (paperclips, etc.).
- Wash delicates in a laundry bag (tights, curtains, underwired bras).
- Fasten zips, do up any buttons.
- Brush sand out of pockets and collars.
- Remove curtain fittings or place in the laundry bag.



### Loading the laundry

Insert large and small items of laundry.

Take care not to trap items of laundry between the washing machine door and the rubber seal.



### Laundry with varying degrees of soiling

light		Wash new items of clothing separately. No prewash. The  SpeedPerfect function can also be selected if desired.
		Pretreat any stains as necessary.
heavy		Insert less laundry. Select Prewash with the programme.



### Soaking

Load laundry of the same colour

Pour soaking agent/detergent into compartment **II** in accordance with the manufacturer's instructions. Turn the programme selector to Cottons 30 °C and press (Start/Reload). After approx. 10 minutes, press Start/Reload to pause the programme. Once the required soaking time has elapsed, press Start/Reload again to continue the programme, or select a different programme.



### Starching

Laundry must not be treated with fabric softener

Starching is possible in all wash programmes using liquid starch. Pour the starch into the fabric softener compartment according to the manufacturer's instructions (if necessary clean it first).



### Dyeing/bleaching

Dye should only be used in normal household quantities. Salt may damage stainless steel. Always follow the dye manufacturer's instructions. **Do not** bleach laundry in the washing machine.

## **Insert for liquid detergent** *model-dependent*

Position the insert for dispensing liquid detergent:

- Remove the detergent drawer completely -> *page 10*.
- Slide the insert forwards.

Do not use the insert (slide upwards):

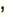
- for gel detergents and washing powder,
- for programmes with  + **Prewash** or the  (Finished in) option



## Care



- **Risk of electric shock.** *Disconnect the mains plug.*
- **Risk of explosion.** *No solvents*

### Machine housing, control panel

- Wipe with a soft, damp cloth.
- Do not use any abrasive cloths, scourers or cleaning agents (stainless steel cleaners).
- Remove detergent and cleaning agent residue immediately.
- Do not clean with a jet of water.

### Cleaning the detergent drawer ...

... if it contains detergent or fabric softener residues.

1. Pull out, press insert down, remove drawer completely.
2. To remove the insert, push the insert up from below with your finger.
3. Clean the detergent dispenser tray and insert with water and a brush and dry it.
4. Attach the insert and engage (connect the cylinder to the guide pin).
5. Push in the detergent drawer.

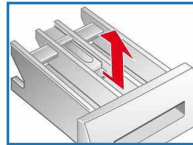
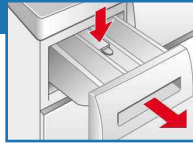

 Leave the detergent drawer open so that any residual water can evaporate.

### Drum

Leave the washing machine door open so that the drum can dry out.  
Rust stains - use chlorine-free cleaning agent, not steel wool.

### Descaling *Ensure there is no laundry in the machine*

This is not necessary if the detergent is dosed correctly. However, if it is necessary, follow the instructions of the descaler manufacturer. Suitable descaling products can be purchased from our website or after-sales service (→ *page 13*).

## Information on the display panel *depending on model*

F: 16	Close the door properly; laundry may be trapped.
F: 17 , 29	Open the tap fully, supply hose kinked/trapped; clean the filter → <i>page 11</i> , water pressure too low.
F: 18	Detergent solution pump blocked; clean detergent solution pump → <i>page 11</i> . Drainage hose/waste pipe blocked; clean the drain hose on the siphon → <i>page 11</i> .
F: 23	Water in the base tub, appliance leaking. Call the after-sales service.
F: 34	Cannot lock washing machine door. Open the door and close it again so that you can hear it "click"; switch the appliance off and on again; set the programme and make individual settings; start the programme.
Other displays	Switch off the appliance, wait 5 seconds and switch on again. If the same display appears again, call the after-sales service → <i>page 13</i> .

## Information about blockages



- **Risk of scalding**
- *Allow the detergent solution to cool down.*
- *Turn off the tap.*



### Detergent solution pump

Turn the programme selector to **Off**, disconnect the mains plug.

1. Open and remove the service flap.
2. Remove the drainage hose from its holder. Remove the sealing cap and allow the solution to drain out. Put the sealing cap back in place.
3. Unscrew the pump cover carefully (residual water).
4. Clean the interior, pump cover thread and pump housing (the impeller in the detergent solution pump must be able to rotate).
5. Put the pump cover back in place and screw it tight. The handle should stand vertically. Insert the drainage hose into its holder.
6. Refit the service flap and close it.

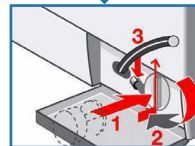
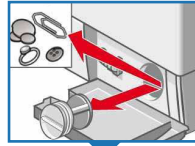
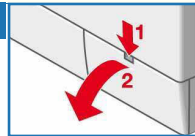

To prevent detergent from flowing down the drain unused during the next wash cycle: pour 1 litre of water into compartment **II** and start the  **Drain** programme.



### Drainage hose at the siphon

Turn the programme selector to **Off**, disconnect the mains plug.

1. Loosen the hose clamp, remove the drainage hose carefully (residual water).
2. Clean the drainage hose and siphon connecting piece.
3. Reattach the drainage hose and secure the connection with the hose clamp.

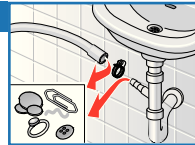



### Filter in the water supply

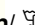

#### Risk of electric shock

*Do not immerse the AquaStop safety device in water (it contains an electric valve).*

- Reduce the water pressure in the supply hose:
1. Turn off the tap.
  2. Select any programme (apart from  **Spin** /  **Drain**).
  3. Press  **Start/Reload**. Allow the programme to run for approx. 40 seconds.
  4. Turn the programme selector to **Off**. Remove the mains plug from the socket.  
To clean the filter:
  5. Disconnect the hose from the tap.  
Clean the filter using a small brush.  
**and/or** for Standard and Aqua-Secure models:  
Remove the hose from the back of the appliance,  
Remove the filter using pliers and clean the filter.
  6. Connect the hose and check for leaks.

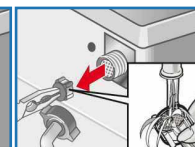
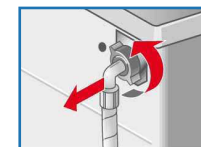



## What to do if ...

- Water is leaking out.
  - Attach/replace the drainage hose correctly.
  - Tighten the screw connection of the supply hose.
- No water supply. Detergent not dispensed.
  - ▷ Start/Reload not selected?
  - Tap not turned on?
  - Filter may be blocked. Clean the filter → page 11.
  - Supply hose kinked or trapped?
- Washing machine door cannot be opened.
  - Safety function active. Programme terminated? → page 4.
  - ▽ (Rinse Hold) = without Final spin selected? → page 3,4.
  - Can be opened by emergency release only? → page 13.
- Programme does not start.
  - ▷ Start/Reload or ⏻ (Finished in) time selected?
  - Washing machine door closed?
  - Childlock active? Deactivate it → page 5.
- Detergent solution does not drain.
  - ▽ (Rinse Hold) = without Final spin selected? → page 3,4.
  - Clean the detergent solution pump → page 11.
  - Clean the waste pipe and/or drainage hose.
- Water not visible in the drum.
  - Not a fault - water below the visible area.
- Unsatisfactory spin result. Laundry wet/too damp.
  - Not a fault - the unbalanced-load detection system has cancelled the spin cycle because of uneven distribution of the laundry. Distribute small and large items of laundry evenly inside the drum.
  - ⚙ (Easy-iron) selected? → page 5.
  - Selected speed too low? → page 5.
- Drum spins gently several times.
  - Not a fault - unbalanced-load detection system is adjusting the imbalance.
- Residual water in the ☼ compartment for care products.
  - Not a fault - the action of the care product is not affected.
  - Clean the insert if necessary → page 10.
- Odour formation in the washing machine.
  - Run the 🧺 **Cottons 90 °C** programme with no load inserted. Use standard detergent.
- Status display 📺 flashes. Appliance has detected a detergent overload.
  - Too much detergent used? Mix 1 tablespoon of fabric softener with ½ litre water and pour into compartment II (not with outdoor or down fabrics).
  - Reduce the detergent dosage for the next wash cycle.
- Loud spinning, vibrations and "walking" during the spin cycle.
  - Appliance feet fixed? Secure the appliance feet → *Installation instructions*.
  - Transport braces removed? Remove the transport braces → *Installation instructions*.
- Display panel/indicator lamps do not function during operation.
  - Power cut?
  - Circuit breakers tripped? Reset/replace the circuit breakers.
  - If the fault occurs repeatedly, call the after-sales service.
- Programme sequence longer than usual.
  - Not a fault - unbalanced-load detection system is adjusting the imbalance by repeatedly redistributing the laundry.
  - Not a fault - foam detection system active - adds an additional rinse cycle.
- Detergent residues on the laundry.
  - Occasionally, phosphate-free detergents contain water-insoluble residues.
  - Use the 🧼 **Rinse** cycle or brush out the laundry after washing.

## What to do if ...

- in Reload mode, ▷ Start/Reload flashes very quickly and an audible signal sounds
    - Water level too high. Not possible to reload laundry. Close door immediately if open.
    - To continue the programme, press ▷ Start/Reload.
- If you cannot correct a fault yourself (switching on/off) or a repair is required:
- Turn the programme selector to **Off** and remove the mains plug from the socket.
  - Turn off the water supply and call the after-sales service → page 13.

## Emergency release e.g. in the event of a power cut



The programme continues when the power supply is restored. However, if the laundry has to be removed, the washing machine door can be opened as follows:



### Risk of scalding.

The detergent solution and laundry may be hot. Allow them to cool down. Do not reach inside the drum if it is still turning. Do not open the door if you can see water through the glass.

1. Turn the programme selector to **Off** and disconnect the mains plug.
2. Drain the detergent solution → page 11.
3. Pull the emergency release downwards with a tool and release. Washing machine door can then be opened.

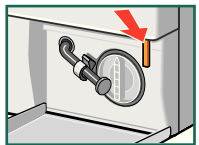

## After-sales service

- If you cannot rectify the fault yourself (Troubleshooting → page 12, 13), please contact our after-sales service. We will always find a suitable solution and will avoid a visit from a service technician wherever possible.
- You can find the contact details for your nearest after-sales service here or in the after-sales service directory (depending on model).
  - **GB** 0844 8928979 (Calls from a BT landline will be charged at up to 3 pence per minute. A call set-up fee of up to 6 pence may apply).
  - **IE** 01450 2655
- Please give the after-sales service the product number (E-Nr.) and the production number (FD) of the appliance.

E-Nr. \_\_\_\_\_ FD \_\_\_\_\_

Product number    Production number

You will find this information:  
on the inside of the washing machine door\*/  
opened service flap\* and rear of the appliance.  
\*depending on the model

- **Rely on the professionalism of the manufacturer.** Please contact us. This will ensure that the repair is carried out by trained service technicians who arrive equipped with genuine spare parts for your appliance.

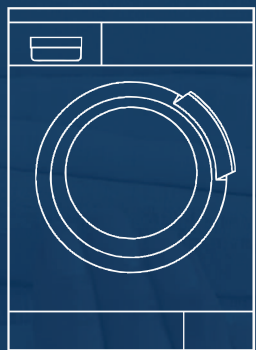

Washing machine

Instruction manual

en



**BOSCH**



Observe the safety instructions on page 8.



Read these instructions and the separate installation instructions before operating the washing machine.